

FOR CIMMCO KRIPA RAPIER

3550

3550 - (WEFT)

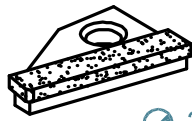

● 3552

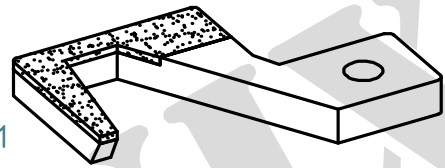

● 3551

FOR MULLER RAPIER

3560 - MBJ 2 (WEFT)

3570 - MBJ 3 (WEFT)

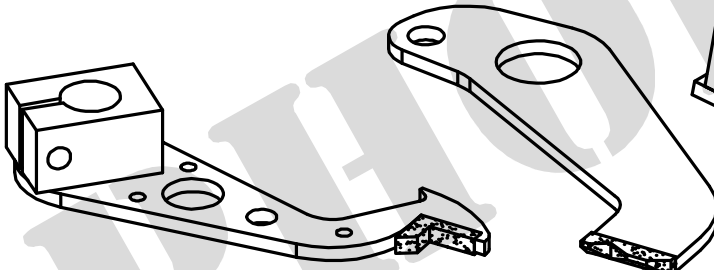

● 3561

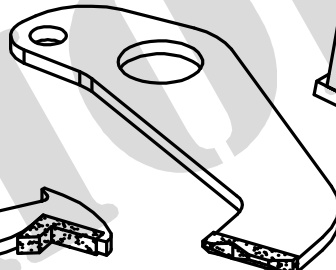

● 3562

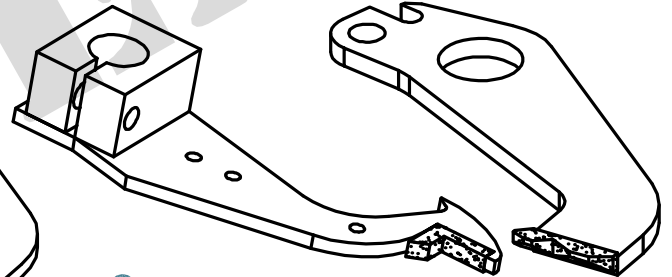

● 3571
179631846

● 3572
179631629

FOR GUSKEN RAPIER

3580 - PLUSH C401 (WEFT & SELVEDGE)

○ 3582



● 3581
905539



● 3583
614180

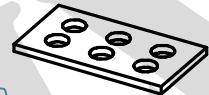

MATERIAL CODE : ● SOLID CARBIDE , ○ HSS , ● BRAZED CARBIDE , ◎ TIN COATED